



Date
Quote #
Project Name
Type



UNB - Bollard

Description:

Circular bollard constructed of fabricated aluminum where top assembly is louvered. UNB sits low to the ground. All external hardware is stainless steel.

Name - Engine - Lumens - CCT - Electrical - Mounting - Lens - Pattern - Options - Finish

Name	Light Engine	Source Lumens(LED)	Color Temp	Electrical
UNB	42 LED (Max)	5460	2700K	UNV 120-277V
			3000K	HLV 347-480V
			3500K	
			4000K	
			5000K	
	Contact for custom	Contact for custom	Contact for custom	

Mounting	Lens	Light Pattern	Options	Finishes
ABT Anchor, bolts & template	OPL Opal lens (Std)	TY5 Type V (Std)	MS Motion sensor	Standard
	CL Clear lens		SD Step dimming	BL Black
			TP Tamperproof hardware	WH White
			TS Tamperproof screws	SG Silver Grey
			PC Button photocell	BZ Bronze
			SF Single fuse	Custom
				CC Custom Color
				See website for custom colors. Contact factory for physical samples.

- Lumens are based on max wattage & 5000K CCT
- IES files available upon request
- Std - Standard Offering





Dimensions & Mounting:

Please note that drawings are not to scale.

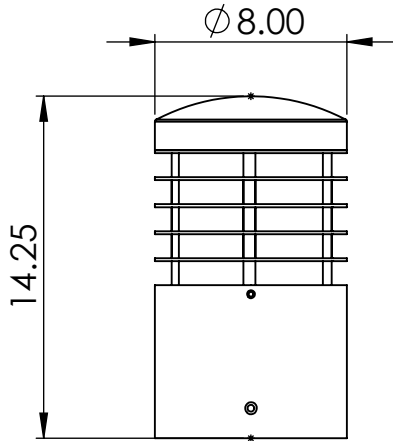

Anchoring details:

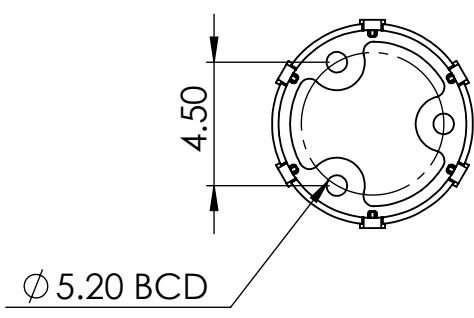

Technical drawing showing a top view of the light fixture. The diameter of the mounting holes is labeled as $\phi 5.20$ BCD. The distance between the mounting holes is labeled as 4.50.

Anchorbolt Size: 1/2" X 12" X 1-3/8"

- Hot dipped Galvanized anchor bolts
- Galvanized steel hex nuts
- Galvanized steel lock washers
- Galvanized steel flat washers

Listing:

Complies to CSA and UL standards.

Polar Graph:

