



Date
Quote #
Project Name
Type



QUAD-O - Light Column

Description:

Heavy duty extruded aluminum housing construction with an opal acrylic lens. Choose between a 6X6 or 8X8 square, and standard heights are 10 or 16 feet. Custom sizes available: contact factory.

Name	Engine	Lumens	CCT	Electrical	Mounting	Lens	Pattern	Options	Finish

Name	Light Engine	Source Lumens(LED)	Color Temp	Electrical
QUAD-O-6	6-10	36 LED (Max)	3000K	UNV 120-277V
	6-16	60 LED (Max)		
QUAD-O-8		10560	3500K	HLV 347-480V
	8-10	48 LED (Max)	4000K	
	8-16	72 LED (Max)	5000K	

Contact for custom

Contact for custom

Contact for custom

Mounting	Lens	Light Pattern	Options	Finishes
ABT Anchor, bolts and template	OAL Opal acrylic lens	TY5 Type V (Std)	SD	BL Black
			MS	WH White
			EM	SG Silver Grey
			TP	BZ Bronze
			TS	CC Custom Color
			PC	See website for custom colors. Contact factory for physical samples.
			GFR	
			COM	
			SF	
			BC	
			TCO	

- Lumens are based on max wattage & 5000K CCT
- IES files available upon request
- Std - Standard Offering



Dimensions & Mounting:

Please note that drawings are not to scale.

Side view

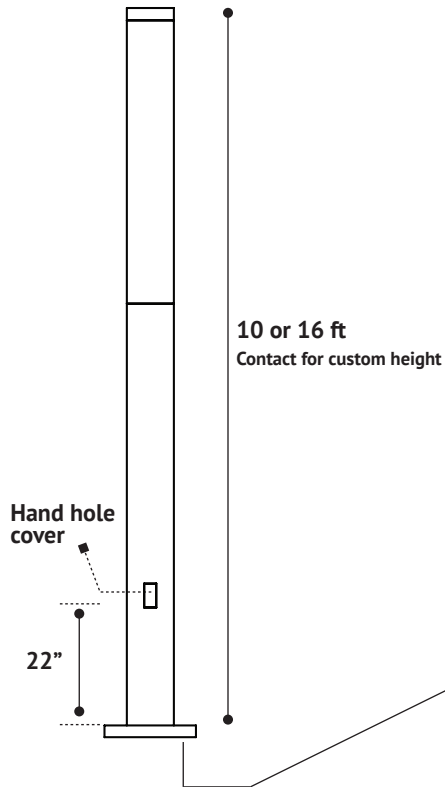

Top view

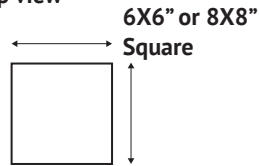

Anchoring details

QUAD-O-6 (Base Plate)

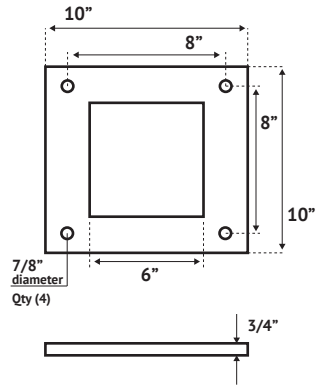

QUAD-O-8 (Base Plate)

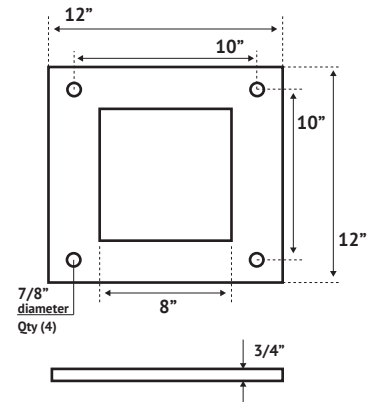

Listing:

Complies to CSA and UL standards.

Polar Graph:

TY5

