



Date
Quote #
Project Name
Type



OTAY - Post Top

Description:

Fixture housing is constructed from die-cast and spun aluminum for durability. Weatherproof silicone sealed gasket for extra protection. Available as a wall mount luminaire.

Name - Size - Engine - Lumens - CCT - Electrical - Mounting - Lens - Pattern - Options - Finish

Name	Light Engine	Source Lumens _{(LED)(5000K)}	Color Temp	Electrical
OTAY	45W LED (Max)	6929	3000K	UNV 120-277V
	150 HPS		3500K	HLV 347-480V
	150 MH		4000K	TT Tri-Tap(HID)
			5000K	MT Multi-Tap(HID)
	Contact for custom	Contact for custom	Contact for custom	

Mounting	Lens	Light Pattern	Options	Finishes
PT3 Post top slips over 3" dia pole	CG Clear glass lens (Std)	TY5 Type V (Std)	SD Step dimming	Standard
				BL Black
PT4 Post top slips over 4" dia pole	CPL Clear polycarbonate lens	TY3 Type III	MS Motion sensor	WH White
			PC Button photocell	SG Silver Grey
WM Wall mount	SAG Clear SAG lens		SF Single fuse	BZ Bronze
			TCO Trespass cut off	Custom
			TP Tamperproof hardware	CC Custom Color
			TS Tamperproof screws	See website for custom colors. Contact factory for physical samples.

- Lumens are based on max wattage & 5000K CCT
- IES files available upon request
- Std - Standard Offering





Dimensions & Mounting:

Please note that drawings are not to scale.

Side view

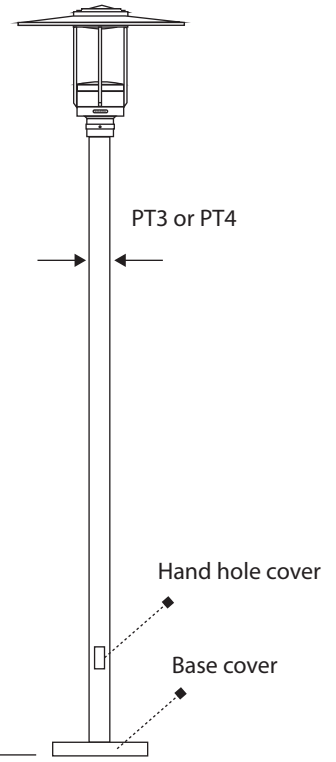
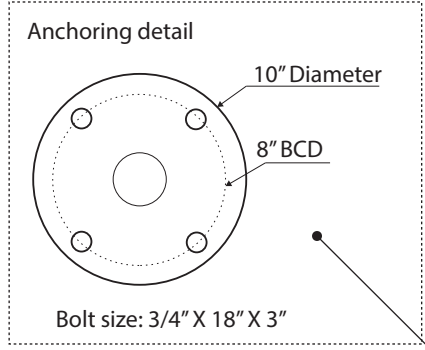
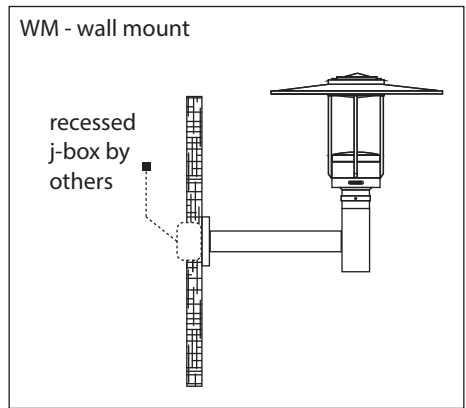
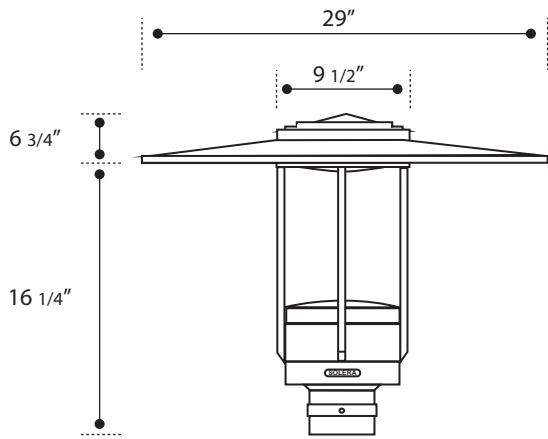

Listing:

Complies to CSA and UL standards.

Polar Graph:

