

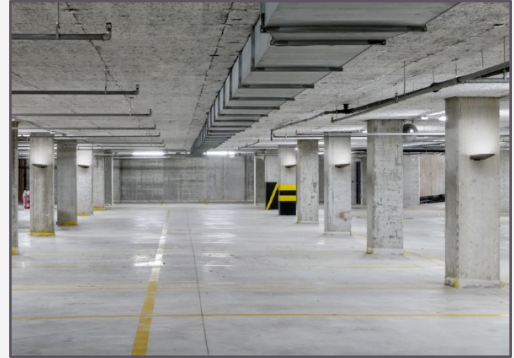

<b>Date:</b>
<b>Type:</b>
<b>Project:</b>



**EXIBRA - WALL MOUNT**

**DESCRIPTION:**

Extruded aluminum housing construction with aluminum end caps and silicone sealed lens gasketing.

Name	Lamping		Lumens	Color Temp	Electrical		Mounting	
	Code	Wattage			UNV	HLV	Code	Description
EXIBRA-S	S	70W LED (Max)	9360	3000K	UNV	120-277V	WM	Wall Mount
EXIBRA-M	M	120W LED (Max)	15600	4000K	HLV	347-480V		
EXIBRA-L	L	320W LED (Max)	33264	5000K				
	*Contact for other wattages		*Contact for custom	*Specify other				

Lens		Light Pattern		Options		Finishes		
OPL	Opal Polycarbonate Lens (Std)	U	Up Light (Std)	DM	0-10V Dimming	BL	Black	
CPL	Clear Polycarbonate Lens			EM	Emergency Battery	WH	White	
PR	Prismatic Lens (K12)			WL	Wet Location	SG	Silver Grey	
				TP	Tamperproof Hardware	BZ	Bronze	
				TS	Tamperproof Screwdriver			
				PC	Button Photocell			
							*See finishes info on website	

✦ Lumens are based on Max Wattage and 5000K CCT

Std - Standard Offering

EXIBRA- \_\_\_\_\_

**Customization Notes:**

▶▶▶ Info on this spec sheet will change without notice as product development is an ongoing process.



## Dimensions & Mounting (drawings are not to scale)

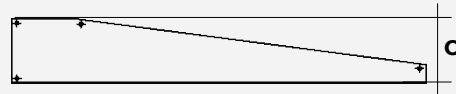
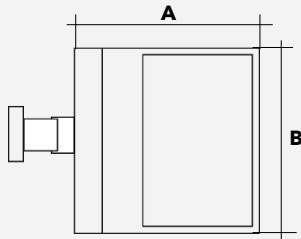

EXIBRA	A	B	C
EXIBRA-S	14"	15"	1"
EXIBRA-M	20"	20"	3 ½"
EXIBRA-L	22"	22"	3 ½"

## Polar Graph

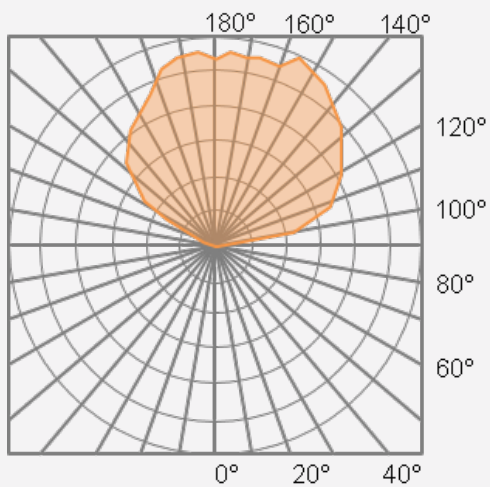

Up Light